



**September 2020 Issue**

**THE PRESIDENT’S MESSAGE...**



Another month is in the books! Thank you for everyone that came out to our meeting at Creative. Also, a big thanks to Chad Bishop covering for my absence at the board and membership meetings in August. Second wettest August on record in the RVA area and I’m sure we are on our way to eclipsing that by the end of the month. I hope everyone stayed safe and made it through the storms and flooding without any damage to themselves or property.

We are working as a board to continue to find the balance of keeping the membership safe and still provide an opportunity to receive some education and networking. If you have any suggestions or concerns, please feel free to reach out to myself or another board member.

Our big push this upcoming month will be our offering of the SFP class to our FM members. We are teaming up with other chapters in the country to put this virtual class together and we would love to have a good showing of FM’s from our community involved. If you

have the opportunity, please promote this class with any FM partners you work with. Every registration helps the chapter so get out there and let everyone know that we are offering it!

IFMA has reviewed their World Workplace event this year and moved to from Chicago to the Dallas/Ft. Worth area December 9-11. If you are interested in attending please visit their website and review registration options as well as the procedures they are putting into place for the event.

Until next month,

Andrew

**MEETINGS**

**September 2020 Membership Meeting**

**Date:** September 15, 2020

**Time:** 4:00-5:00 pm

**Place:** ZOOM link —Dominion Energy’s OJRP HQ Implosion

**Cost:** Certified Members & Hosts: FREE  
Members \$15, Non-members \$20

**RSVP:** by Sept 14th at [ifmarva.com](http://ifmarva.com)  
\*\*\*\*\*

**Next Board Meeting:**

**Date:** Tuesday, September 1, 2020

**Time:** 4:30 pm

**Place:** Fast Signs or Virtual  
\*\*\*\*\*

**Next Membership Meeting**

**Date:** October 13, 2020

**Time:** 5:30 pm

**Place:** TBD

## AUGUST MEETING REPORT

Creative Workplace Interiors & Technology hosted our August 11, 2020 Membership meeting. Carl Hooper, Chief Sales Officer/President, Lara Williams, Strategic Account Manager, and Katherine Gordan, Workplace Specialist shared information on their experiences and role with Creative as well as provided tours of their office.

They showed us how they are helping customers transform their offices due to COVID-19.

Creative's mission has never been clearer: **to advance the way people live, learn & work**. They do this by combining deep **insights into human behavior** with leading

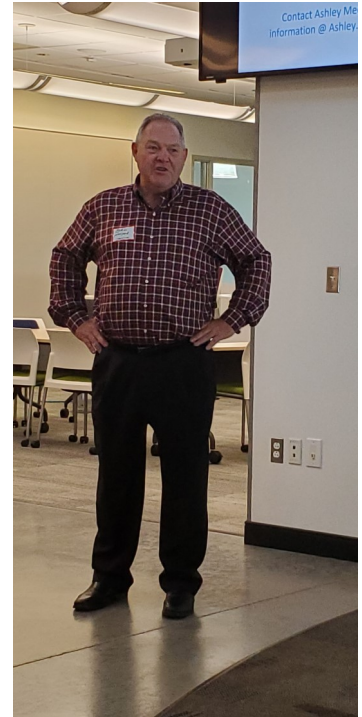

technology, furniture, and architectural products to create inspiring, uplifting, & beautiful spaces.

Their Ashland, VA office and showroom has display setups to showcase their products, from enclosed meeting areas to open cubicle(s) and collaboration seating.

The original company, Everett Waddey began in

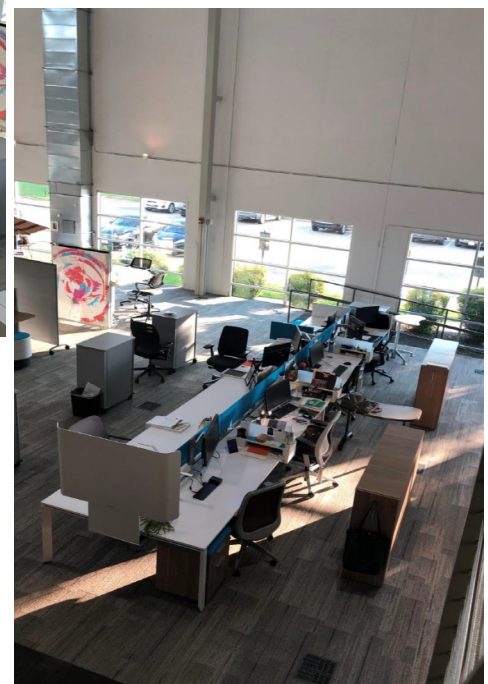

in the early 1900's as a printing and engraving company. In the 1920's, as the firm grew, a state-of-the-art facility was built in downtown Richmond that included a commons and roof terrace exclusively for the use and recreation of the employees. He knew that supporting employee health and well being was not only the right thing to do, but also the best way to get the most from his people. As the company grew it evolved to include high-quality office supplies and workplace furnishings.

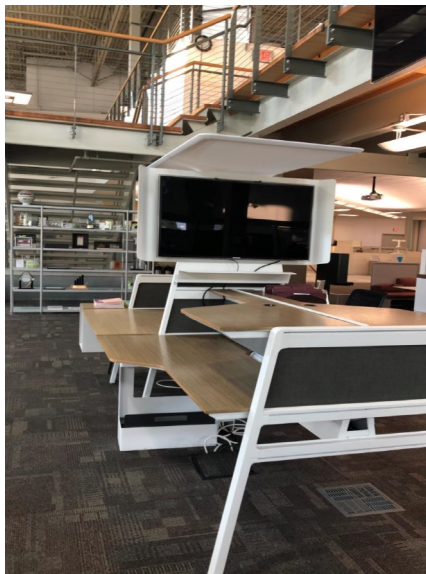

When Bob DeLille purchased the firm in 1995, it became **Creative**.

**Thanks again to Creative for hosting us!**

*If anyone has any ideas for future meetings please contact Ashley Hawks Medlin.*

## 2020/21 Board of Directors

### OFFICERS

#### **President**

Andrew Baker - 252-725-0457  
[andrew.baker@pauldavis.com](mailto:andrew.baker@pauldavis.com)

#### **Vice President**

Chad Bishop—804-564-4652  
[cbishop@svmervices.net](mailto:cbishop@svmervices.net)

#### **Secretary**

Michael Calkins - 804-822-4350  
[michael@trolleyhouseva.com](mailto:michael@trolleyhouseva.com)

#### **Treasurer**

Rob White - 804-624-1977  
[rob.white@fastsigns.com](mailto:rob.white@fastsigns.com)

#### **Immediate Past President**

Blake Bishop - 804-822-1242  
[michael.b.bishop@dominionenergy.com](mailto:michael.b.bishop@dominionenergy.com)

### CHAPTER ADMINISTRATORS

#### **Administration**

Adam Larsen  
[Adam.Larsen@allegion.com](mailto:Adam.Larsen@allegion.com)

#### **Technical Support**

Steve Weeks  
[sweeks@amstedrail.com](mailto:sweeks@amstedrail.com)

### COMMITTEE CHAIRS

#### **Membership**

Mary Crawford  
[mcrawford@svmervices.net](mailto:mcrawford@svmervices.net)

#### **Programs**

Ashley Hawks Medlin  
[ashley.hawks@jci.com](mailto:ashley.hawks@jci.com)

#### **Sponsorship**

Brian Workman  
[BWorkman@MOII.com](mailto:BWorkman@MOII.com)

#### **Social Media/Web Site**

Steve Weeks  
[sweeks@amstedrail.com](mailto:sweeks@amstedrail.com)

#### **Public Relations**

Sherry Grady  
[SGrady@wrichmond.org](mailto:SGrady@wrichmond.org)

#### **Newsletter**

Beth Gay  
[beth@buckinghamgreenery.com](mailto:beth@buckinghamgreenery.com)

#### **Hospitality**

Mary Harris  
[mharris@permitzip.com](mailto:mharris@permitzip.com)

#### **Professional Development**

Jim Mallon, CFM, Retired  
[mallonj1313@gmail.com](mailto:mallonj1313@gmail.com)

#### **Golf Tournament**

Tim Hume, CFM  
[timh5427@gmail.com](mailto:timh5427@gmail.com)

#### **Founding Member Advisor**

Ranny Robertson, CFM, Retired  
[grjr41@gmail.com](mailto:grjr41@gmail.com)



## WANT TO IMPACT... PEOPLE? THE PLANET? AND PROFITS?

By achieving your SFP (Sustainability Facility Professional) credential, you will learn how to add value to any facility and organization in a sustainable way. For the third year in a row, a few select chapters collaborated to create a virtual classroom via an online webcast of the SFP program. **Don't miss this opportunity for the low member price of \$1,800.**

The complete course will be presented in 14 half-day sessions over the course of four months, which will allow everyone to participate easily throughout the US. The courses will be offered in hub locations to create connections with other members seeking to accomplish this practical and effective credential.

### COURSE DATES & TIMES

OCTOBER	NOVEMBER	DECEMBER
6-7 10AM-2PM EST	12-13 10AM-2PM EST	1-2 10AM-2PM EST
13-14 10AM-2PM EST	17-18 10AM-2PM EST	7-8 10AM-2PM EST
27-28 10AM-2PM EST	<b><u>VISIT <a href="http://WWW.IFMARVA.COM">WWW.IFMARVA.COM</a> TO REGISTER</u></b>	



## MEMBERSHIP CORNER

Mary Crawford—Membership

**On behalf of the Chapter Board, “Thank You” to the following NEW Members for joining this month:**

Graham Allen JLL  
[graham.allen@am.jll.com](mailto:graham.allen@am.jll.com)

Benny Bowman  
Worth Higgins & Associates, Inc.  
[b.bowman@whaprint.com](mailto:b.bowman@whaprint.com)

Anthony Corcoran, CFM  
[anthony.c.corcoran.cfm@gmail.com](mailto:anthony.c.corcoran.cfm@gmail.com)

Ken Myers  
Lewis Ginter Botanical Garden  
[kenmyers2@comcast.net](mailto:kenmyers2@comcast.net)

Rachel Pest  
[rachel.pest@convergint.com](mailto:rachel.pest@convergint.com)

Brandon Snead  
UNOS  
[brandon.snead@unos.org](mailto:brandon.snead@unos.org)

**On behalf of the Chapter Board, “Thank You” to the following Members for Re-newing and/or Rejoining this month:**

Jordan Crespi  
[jordan.crespi@baesystems.com](mailto:jordan.crespi@baesystems.com)

Glenn Custis  
Draper Aden Associates  
[gcustis@daa.com](mailto:gcustis@daa.com)

Clarence Elliott  
UNOS  
[clarence.elliott@unos.org](mailto:clarence.elliott@unos.org)

Jerry Howard  
SolarFilm  
[jerry@solarfilmva.com](mailto:jerry@solarfilmva.com)

Sherry White  
UNOS  
[sherry.white@unos.org](mailto:sherry.white@unos.org)



## THANK YOU RICHMOND!

We want to give back to the community.

With virtual school beginning, we recognize that parents will have their hands full. And as a caterer, we figure why not help with food?

15% of Family Meals sales go to a local non-profit of the week.

Sept 8 – Nov 7  
Easy heat & serve - feeds 4  
\$69/package

Follow Groovin' Gourmets for more announcements





## SEPTEMBER VIRTUAL MEMBERSHIP MEETING

### *A Deeper Look at the Implosion of Dominion Energy's OJRP HQ*

**WHEN:** September 15, 2020 4:00-5:00 pm

**WHERE:** ZOOM Link

We hope you will join us for our next chapter meeting for an exciting virtual panel discussion on the implosion of the Dominion Energy OJRP Headquarters building back in May. We will be joined by panelists Ryan Saulsbury, Executive Vice President of Hourigan; Joel Miner, Project Director with Clayco; Will Booker, Regional Manager with D.H. Griffin Companies; and Jessica Buchta, Manager of Facilities Management—Capital Projects with Dominion Energy. The experts will discuss the comparison of mechanical demolition versus implosion demolition,



the community outreach process, and finally the actual OJRP demolition process.

If your company would like to sponsor this unique webinar please reach out to Brian Workman ([bworkman@moii.com](mailto:bworkman@moii.com)) for an opportunity to showcase your company during the event.

**Time:** 4:00-5:00pm

**RSVP by:** Monday, September 14, 2020

**THANK YOU TO OUR MEETING SPONSOR!**



**Cost\*:**

Certified Members/Hosts: **FREE**  
Members: **\$15**  
Non-Members: **\$20**

\* Registrations are required prior to event.

Questions? Contact [Ashley.Hawks@jci.com](mailto:Ashley.Hawks@jci.com) or [ifmarich-va@gmail.com](mailto:ifmarich-va@gmail.com)

### Thank you to our 2020 Annual Chapter Sponsors!





**IFMA<sup>TM</sup> RVA**  
International Facility Management Association

**27th Annual Richmond IFMA**  
**Golf Tournament**

**Monday, September 21, 2020**

**Hermitage Country Club**

**Registration & Lunch—10:30am**

**Shotgun Start—12:00**

**Dinner to Follow**

**To Register, Contact Tim Hume**

**(804) 240-0018 or [twohumes@yahoo.com](mailto:twohumes@yahoo.com)**

***SIGN UP NOW—ONLY 9 SPOTS REMAINING!!!***

***THANKS TO ALL THAT HAVE REGISTERED!***

***Volunteers are still needed. Contact time if available!***

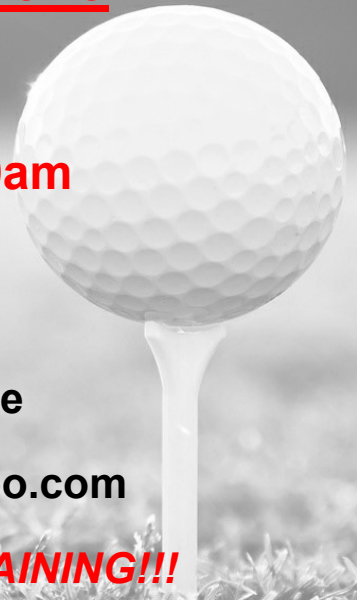

**Visit our Local Chapter Web Site**

**[www.ifmarva.com](http://www.ifmarva.com)**

From one of our valued annual sponsors

## Touchless solutions by Allegion™

Studies have found that viruses can survive on certain surfaces for days unless properly disinfected. As a result, facilities across the world are elevating their efforts to provide clean, safe environments. This includes access hardware surfaces.

People touch door hardware, like exit devices and levers, several times a day, especially in high-traffic applications. From the main entrance of an office building to doors throughout a hospital, best practices show that keeping these areas clean and disinfected help prevent the transmission of contaminants. [Read more about our disinfecting recommendations.](#)





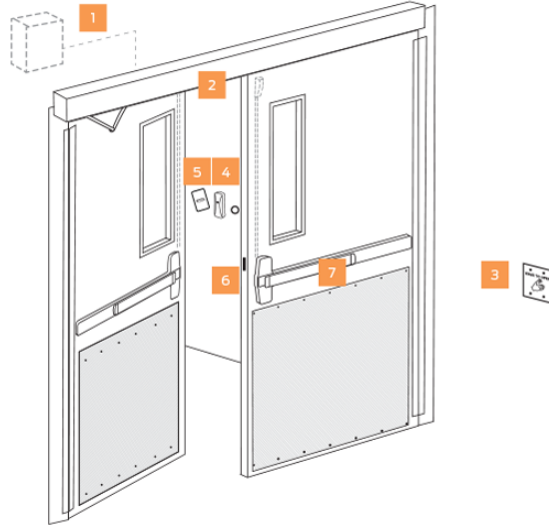

Additionally, many are considering touchless access solutions. These can reduce contact transmission by decreasing the number of surfaces pedestrians touch in a facility, which thereby decreases opportunities for exposure. A common way to accomplish touchless operation is by pairing low energy automatic operators with actuators or readers.

Allegion's priority is to keep people safe where they live, work and thrive. A comprehensive portfolio of solutions is available to create touchless openings in multifamily properties, healthcare facilities, commercial offices, K-12 schools and higher education campuses. Learn more about these solutions below. [Have an upcoming project? Contact an Allegion expert to discuss your needs.](#)



### Wiring diagrams

Wiring and riser diagrams for common touchless applications are available. They show how all the components of the solution work together. [View diagrams.](#)

<p><b>1</b></p>  <p><b>Accessories</b></p> <p>Allegion offers a complete portfolio of system components used as part of an access control system in touchless applications, like power supplies and door position switches.</p>	<p><b>2</b></p>  <p><b>Automatic operators</b></p> <p>For applications where most pedestrians operate the door electronically, consider electromechanical automatic operators. These utilize a motor gearbox and control box to perform the opening and closing function.</p> <p><a href="#">Check out this flow chart to help choose the right auto operator.</a></p>	<p><b>3</b></p>  <p><b>Actuators</b></p> <p>Actuators provide a signal that activates the automatic operator, including "wave to open" or contactless readers.</p> <ul style="list-style-type: none"> <li>No-touch actuators are installed in place of push buttons and comply with ANSI 156.19 low energy standards. When a pedestrian waves his or her hand in front of the wall plate, the technology senses the motion and acknowledges intent to enter. No contact with an actuator, door handle, push bar or door is required.</li> </ul> <p><a href="#">View actuators.</a></p>	<p><b>4</b></p>  <p><b>Contactless readers</b></p> <p>Multi-technology readers can be used as part of an access control system to actuate automatic operators for authorized individuals. These readers recognize a variety of credential technologies. Users simply present their credentials to gain entry without making contact with the reader or door.</p> <p><a href="#">View readers.</a></p>
<p><b>5</b></p>  <p><b>Credentials</b></p> <p>A contactless credential does not require a user to touch the reader; simply present the card near it. Allegion offers a full range of credential technologies, including secure smart options.</p> <p><a href="#">View credentials.</a></p>	<p><b>6</b></p>  <p><b>Electric strikes</b></p> <p>Electric strikes release the keeper allowing the door to open upon signal from the access control system. They can be used as part of a touchless system when paired with an automatic operator. Von Duprin's offering includes strikes for a range of applications, including high-use openings. Locknetics offers cost-effective solutions for common applications with a versatile portfolio of field-configurable options. These are great for retrofit applications.</p> <p><a href="#">View electric strikes.</a></p>	<p><b>7</b></p>  <p><b>Exit devices</b></p> <p>Energy-efficient electrified exit devices, such as Von Duprin QEL and Falcon MEL, electronically retract the latchbolt upon signal from the access control system. These can be paired with automatic operators for touchless applications.</p> <p><a href="#">View exit devices.</a></p>	

**Want to talk to an expert?**

We are united around a common desire to protect our communities today while innovating for tomorrow. Questions?

[CONTACT US](#)



From one of our valued annual sponsors

# **FASTSIGNS**<sup>®</sup>

## **IS OFFERING TOUCH-FREE SERVICE**

- Call or email our stores (see below) to discuss your current or future needs with a FASTSIGNS visual communications specialist.
- Discuss solutions and communicate ideas using design proofs electronically through email.
- Upon completion, your project can be picked up in our store's lobby or delivery options are also available.



**West End/Richmond**  
10817 West Broad Street  
Glen Allen, VA 23060  
(804) 270-7446

**SouthSide/Richmond**  
11523 Midlothian Tpk.  
Richmond, VA 23235  
(804) 272-7446

**Fredericksburg**  
4500 Plank Road  
Fredericksburg, VA 22407  
(540) 548-0028

**Downtown/Richmond**  
532 East Main Street  
Richmond, VA 23219  
(804) 644-7446

From one of our valued annual sponsors



We are open and fielding calls for deep cleaning sterilization and soon enough will be offering Clorox 360 fogging capabilities!

We appreciate your help greatly in getting the word out there that we are here to help and FM's can call me directly at (804)564-4652.

Chad Bishop  
Account Executive  
ServiceMaster Clean  
(804)564-4652  
[cbishop@svmservices.net](mailto:cbishop@svmservices.net)



**HERE TO HELP  
YOU DISINFECT**

Call Us Today  
**804.378.2323**  
Mention IFMA

**SERVPRO®**  
Richmond Chesterfield Henrico Tri-Cities, Plus

**IICRC  
CERTIFIED**

Schools | Hospitals | Medical Offices | Retailers | Commercial Offices  
Senior Living Facilities | Residential Lobbies | Public & Common Areas

From one of our valued annual sponsors



**Public safety is at the front line of the current pandemic. As Facility Management professionals, you help to ensure the health of employees and optimal utilization of physical assets. Draper Aden Associates continues to be a partner to IFMA and is at your side. We are here to assist you so that your facilities meet current needs and are prepared for future demands. The unexpected vacancy of commercial office space, industrial manufacturing facilities, parking garages and surfaces, provides an opportunity to conduct physical inspection(s) and assessment of your infrastructure.**



From one of our valued annual sponsors

**By combining traditional methodologies with state-of-the-art inspection equipment (i.e. our remote sensing survey equipment that minimizes site time and promotes social distancing) and virtual design, Draper Aden Associates as well as our network of industry professionals will partner with you and your facilities team to identify, document, and develop a prioritized strategy for necessary maintenance, repairs, and improvements.**

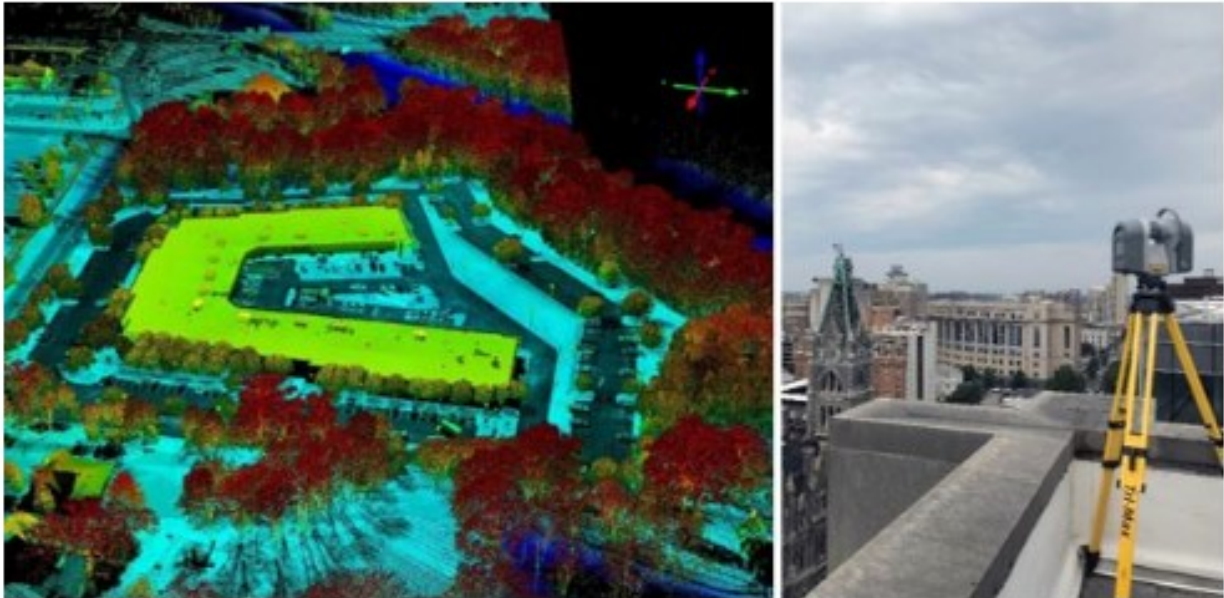

**With more than 45 years of experience providing inspection and assessment services for private and public infrastructure including office, commercial, institutional and educational buildings, we can provide the investigation and analysis today that will allow you to continue to optimize the performance and utilization of your facility assets in the future.**

**Working together we are here to help you make a Lasting Positive Impact.**

**Contact Draper Aden Associates:**

**Phone: (804) 264-2228**

**Lee O. White, LS**

Vice President/Managing Principal  
Marketing & Business Development

**Mobile: (804)869-2228**

**Email: [lwhite@daa.com](mailto:lwhite@daa.com)**

**Online: <https://daa.com/contact-us/>**



## WORKING REMOTELY

Here are a few links from our partners that might help regarding working remotely:

<https://www.knoll.com/knollnewsdetail/tips-for-healthy-work-experience>

<https://www.knoll.com/knollnewsdetail/strategies-for-managing-a-remote-team>

<https://www.knoll.com/knollnewsdetail/tips-for-remote-work-success>

<https://www.workdesign.com/2020/03/effective-remote-working-key-steps-and-strategies-for-success/>

<https://www.workdesign.com/2020/03/people-first-emotional-culture/>

From IFMA International:

<https://www.ifma.org/know-base/coronavirus-preparedness-resource-center>

From Gensler Research Institute:

<https://www.gensler.com/research-insight/blog/what-happens-when-we-return-to-the-workplace?q=what%20happens%20when>